

ITEM NO.	PART NUMBER	DESCRIPTION	QTY.
1	10530/00	POST COINED, 208 SERIES	2
2	10972/00	HUB, TRANSITIONAL 3RING	2
3	10978/00	ESCUTCHEON HANDLE BASE COINED, 3RING, COINED SERIES	2
4	2-104	MOUNTING KIT WITH BROACH	2
5	92248	SET CREW, CUP POINT 8-32 UNC, 1/8" L.	2
6	P23073/00	18" KLD TOWEL BAR	1
7	P39001	HEX KEY 5/64, FOR 8-32 SET SCREW	1

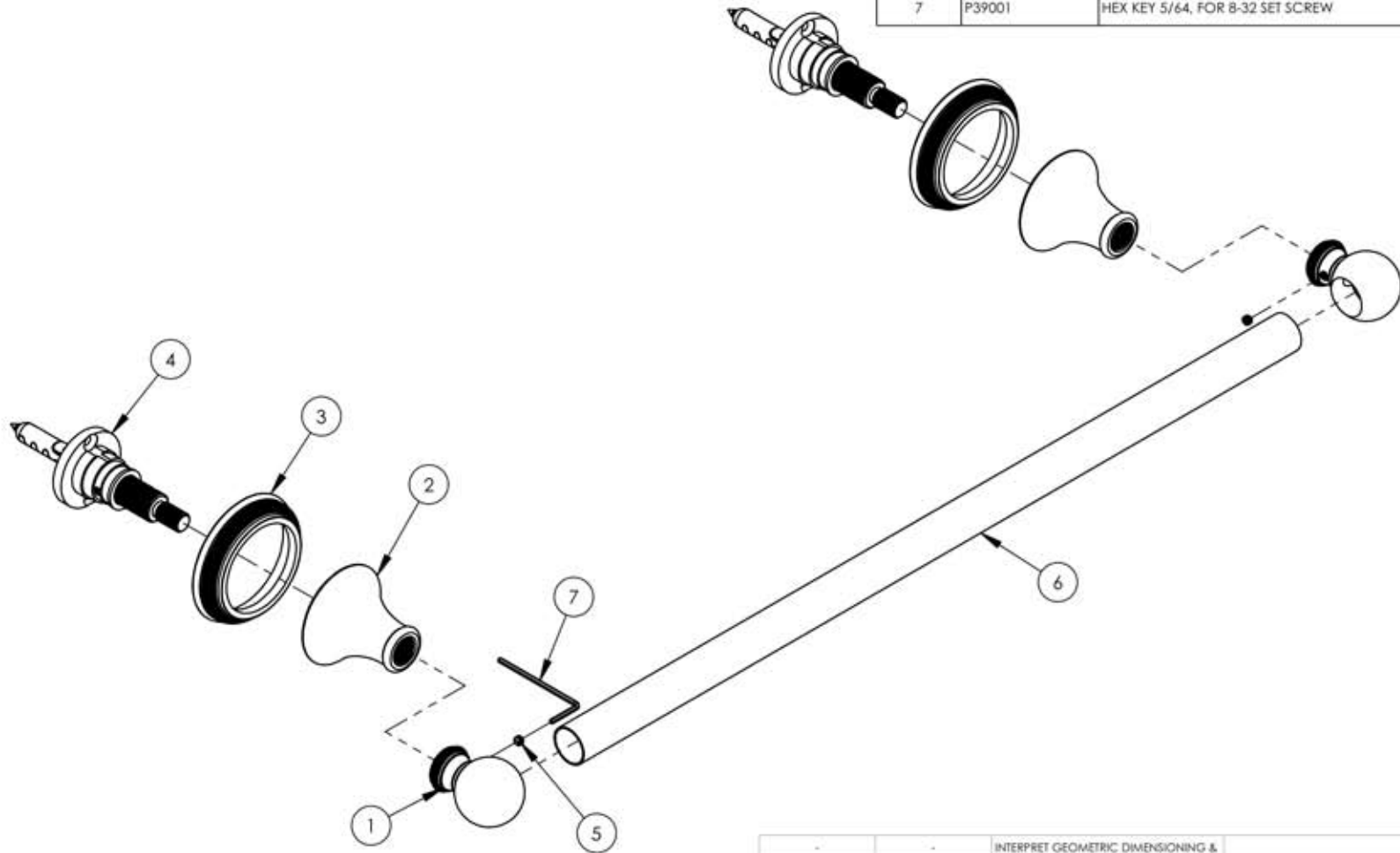

ZONE	REV.	DESCRIPTION	DATE	APPROVED
REVISIONS				
1261 LOGAN AVENUE COSTA MESA, CALIFORNIA 92626 PHONE: 714.361.4800 FAX: 714.617.3120		PHYL RICH®	<b>PROPRIETARY AND CONFIDENTIAL</b> <small>THE INFORMATION CONTAINED IN THIS DRAWING IS THE SOLE PROPERTY OF RISS MANUFACTURING. ANY REPRODUCTION IN PART OR AS A WHOLE WITHOUT THE WRITTEN PERMISSION OF RISS MANUFACTURING IS PROHIBITED.</small>	
Defining Luxury Since 1959				

-		INTERPRET GEOMETRIC DIMENSIONING & TOLERANCING IN ACCORDANCE WITH ASME Y14.5-2009 & ASME Y14.41-2003 STANDARDS. UNLESS OTHERWISE SPECIFIED, DIMENSIONS ARE IN INCHES. TOLERANCES ARE:		
NEXT ASSY	USED ON	FRACTIONS ±1/64"	DECIMALS X.X: ±.1 X.XX: ±.01 X.XXX: ±.005	ANGULAR ±5°
APPLICATION		MATERIAL	NAME	DATE
FINISH		DRAWN	LLO	9/24/2015
DO NOT SCALE DRAWING		CHECKED	GRE	

TOWEL BAR 18", COINED SERIES		
SIZE	ASM/PRT NO.	REV
A	208-70/00	-
SCALE: 1:3	WEIGHT: lbs.	SHEET 1 OF 2

5

4

3

2

1